

LOW SENSORY VIEWING FOR VISITORS WITH AUTISM OR SENSORY SENSITIVITY

INFORMATION SHEET

GALLERY OF MODERN ART (GOMA) | SAT 27 JUL 2019 | 9.00AM – 10.00AM | FREE

For full building floor plans go to: www.qagoma.qld.gov.au/maps

GENERAL INFORMATION

- Certain items are not allowed in the Gallery. This is for safety of the artworks on display. You cannot bring in food and drinks, large items such as backpacks and sticky items such as putty.
- You can store items that you are not allowed to take into the Gallery in the cloakroom.
- You can take quiet sensory tools/stimming toys in to the Gallery.
- Please do not touch the artworks. This can cause damage.
- Due to room capacity in Ben Quilty: Family Portraits, we ask that prams are parked in a designated area nearby.
- The air conditioning vents at GOMA are in the floor throughout the building.
- The air conditioning in GOMA is maintained at 21.5 degrees. This is the best temperature to conserve the artworks. You may like to bring an extra layer of clothing to keep warm.

Note: QAG and GOMA are generally less crowded between 3.00pm and 5.00pm. We are open every day of the year except Good Friday, Christmas Day and Boxing Day.

THE EXHIBITIONS

**Margaret Olley: A Generous Life
Quilty**

Ben Quilty: Family Portrait

- These exhibitions are free and no ticket is required for entry.
- You can take photos, but you can't use a flash.
- The three exhibitions are located on the entry level of GOMA. Access to exhibitions on other levels of the gallery is from 10.00am.
- Included are paintings, drawings, sculptures, photographs and video.
- Ben Quilty: Family Portrait is an interactive exhibition for children and families, presented by the Children's Art Centre.
- In the corridor outside Family Portrait there are 3D models of the surface of 3 artworks for visitors to experience the textural depth of Ben Quilty's painting style.

For more information about the exhibitions visit www.qagoma.qld.gov.au/whats-on/exhibitions

SENSORY EXPERIENCES

- Signs in the gallery will point out the location of high sensory areas.
- Some areas within the gallery are brightly lit while others have low lighting.
- You can wear a cap and/or sunglasses if you are sensitive to bright light.
- There are a small number of videos with sound.
- The sound will be lowered or switched off where possible between 9.00am and 10.00am.
- You can bring noise cancelling headphones if you are sensitive to sound.
- Some artworks may trigger emotions or memories. The 'Quilty' exhibition includes themes around war and the refugee crisis.
- Some of the images portrayed in 'Quilty' may appear distorted or grotesque to some viewers.
- There are two quiet zones which are indicated on the floor plans. One is at the river end of the building on the ground floor and this space is filled with natural light. The other is one floor up, at the top of the escalators. This area is dimly lit. Both spaces have comfortable seating.

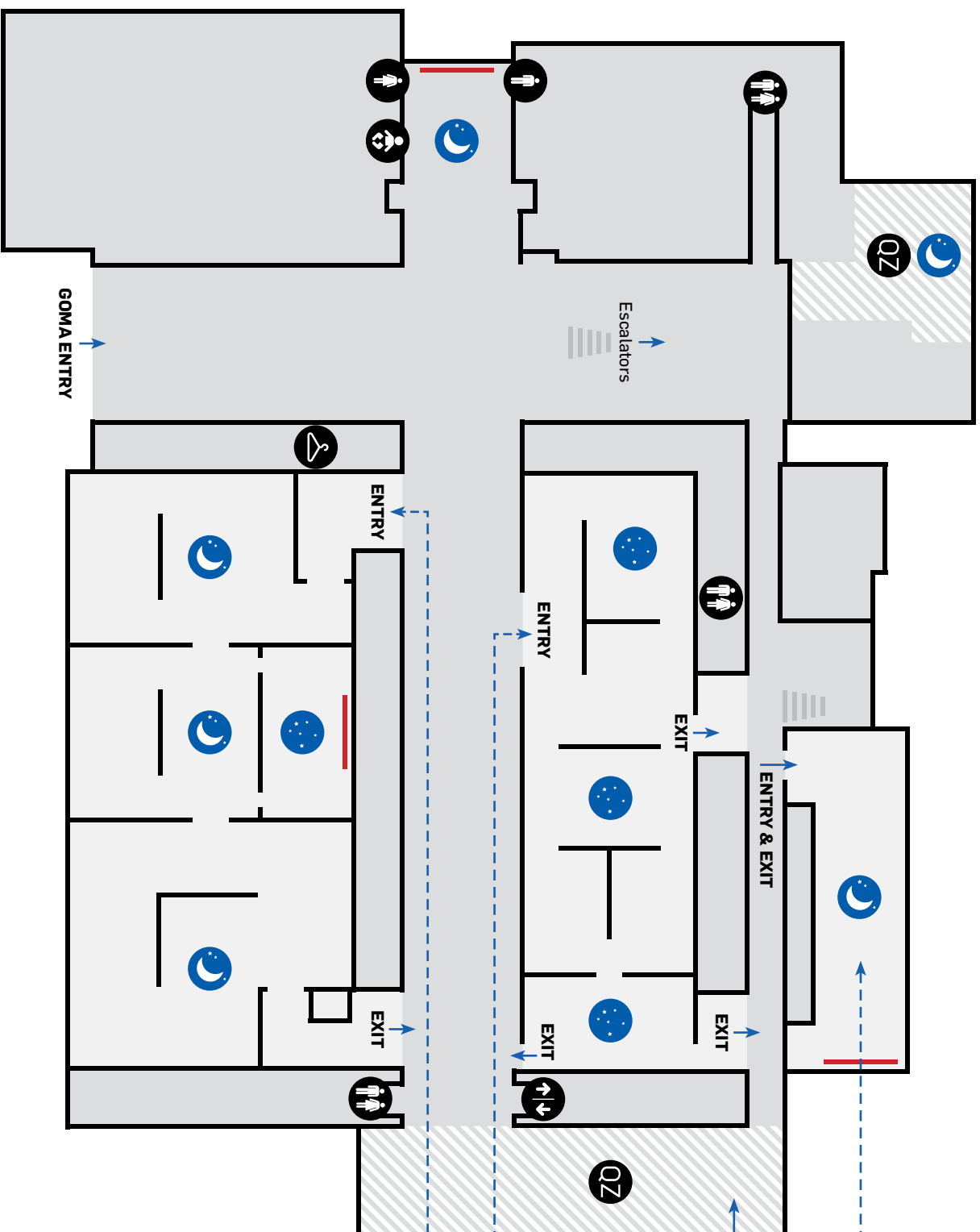

BEN QUILTY
Family Portrait

Bright natural light

QUILTY

Margaret
Olley —

A Generous Life

-  TOILETS
-  CHANGE ROOM
-  CLOAKROOM
-  LIFTS
-  QZ QUIET ZONE
-  LOW LIGHT
-  VERY LOW LIGHT
-  VIDEO SCREEN